



COLLEGE OF PHARMACY

# Riffe Student Learning Center

Help create modern classrooms and study spaces for pharmacy students.

*The following classroom imagery shown is 3D rendered. The final spaces may vary.*



# The Project

---

The College of Pharmacy has been a top-ranked pharmacy program for more than 20 years.

We've remained a leader in pharmacy education by consistently advancing our teaching practices to include modern pedagogy that prepares students to advance the pharmacy profession and patient-centered care across Ohio and around the globe.

This project will allow us to create a state-of-the-art student center that revolutionizes how students learn, meet and work together in our facilities.

**These spaces are vital for the college's Inquire, Innovate, Involve (I3) curriculum which emphasizes small group work and active-learning teaching methods.**

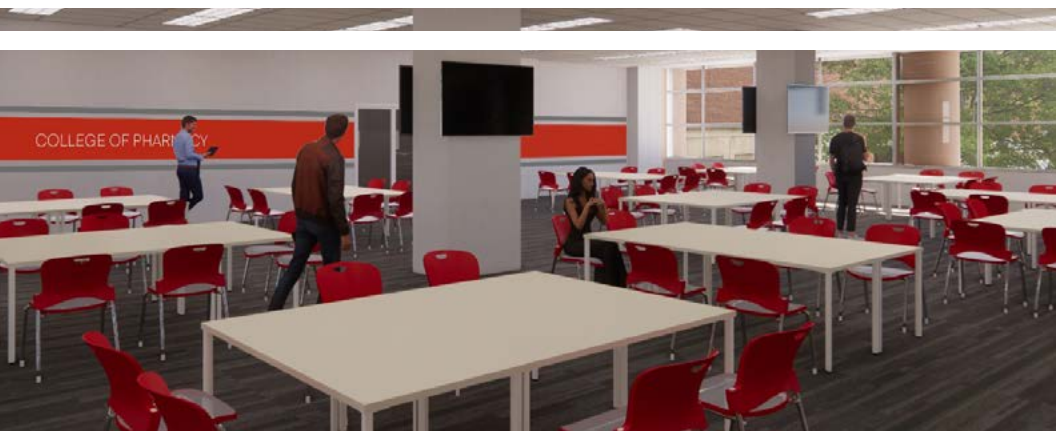



The college will renovate the former Pharmacy Library in the Riffe Building to create **two** 150-seat active learning classrooms overlooking Ohio Stadium and the Medical Center. These renovations will also create student-focused spaces including a new student lounge, individual study spaces and small group meeting rooms.



The new space will provide a modern environment for student learning, improving accessibility and creating more opportunities for technology usage in the classrooms. Students will also have small group meeting spaces that will provide an environment conducive for collaboration.

# The Layout

---

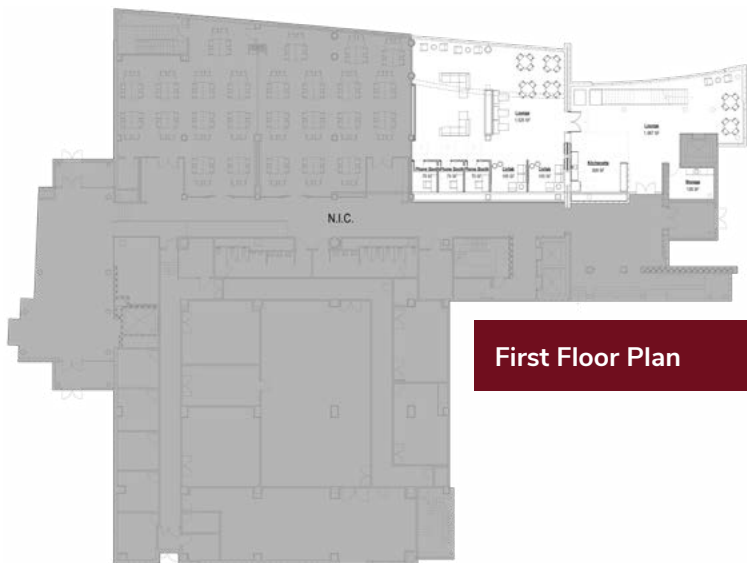

First Floor Plan

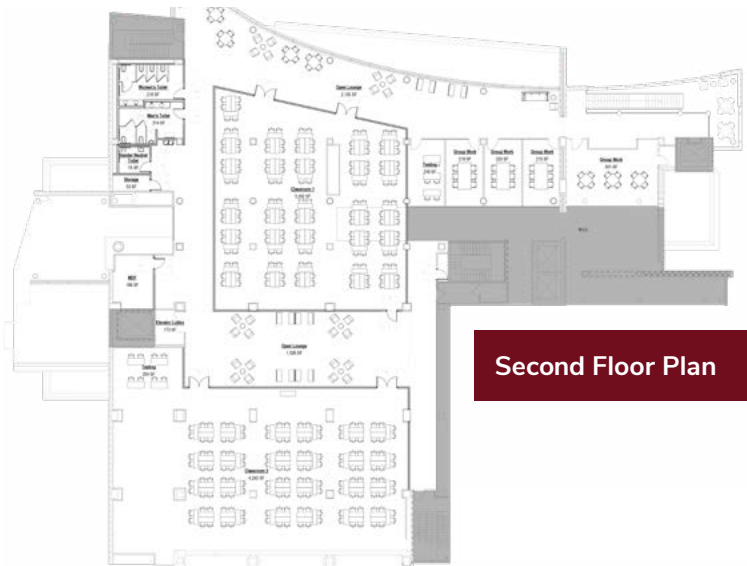

Second Floor Plan



# The Opportunity

---

**This project will add 11,000 square feet of new learning space to the college.**

Leveraging funds from the university to offset some of the expense, the project is anticipated to cost the college between \$1.5-\$2 million. As we begin work on this exciting endeavor, we invite your support and participation. Specific giving options will provide you with room naming and recognition opportunities

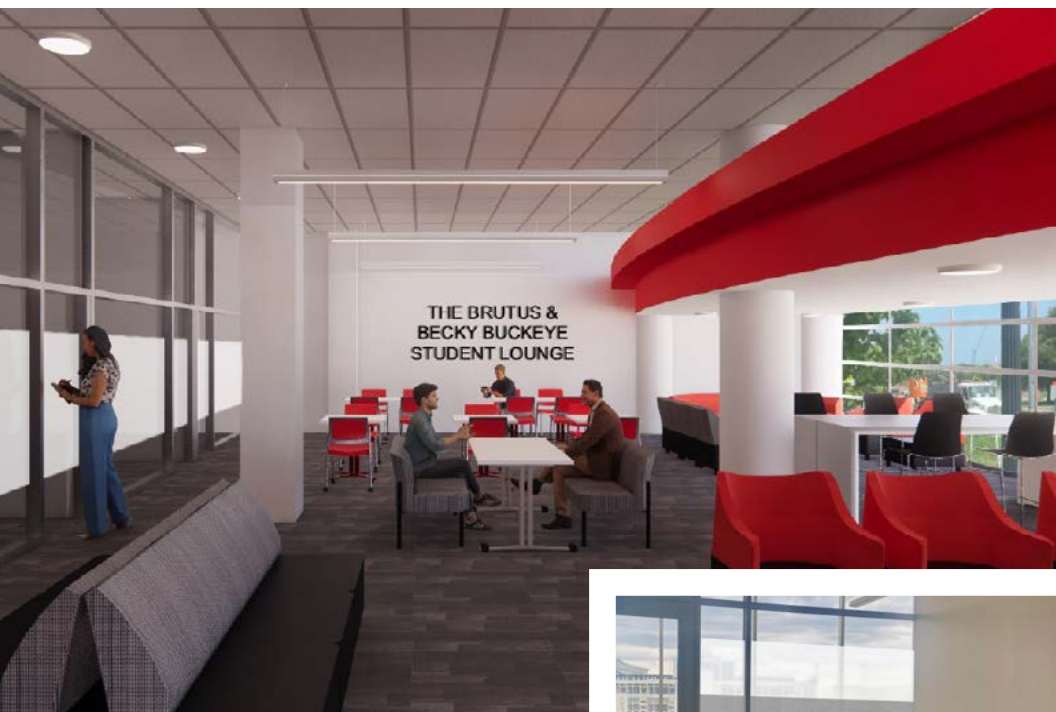

The college is preparing future health care leaders, ready to disrupt and positively influence the profession. The spaces that they learn in must reflect the modern, ever-changing pharmacy landscape.



## Student Lounge

A 2,040-square-foot hub where students will study, collaborate, relax and recharge between classes and study sessions.



## Classrooms

Classrooms ranging in size from 3,300 to 4,200 square feet will provide cutting-edge educational spaces featuring state-of-the-art technology and flexible furniture. Classrooms will feature stunning views of Ohio Stadium and the Wexner Medical Center.



## Individual and Group Study Rooms

Several individual and group study spaces will be incorporated, including private phone booths, group collaboration spaces and meeting rooms. Ranging in size from 70 to 500 square feet, these spaces will provide flexible options for student work.



## Buckeye Leaves

The entire suite will feature a décor of individual *buckeye leaves* featuring recognitions and messages from project supporters. Donors may participate in this opportunity by contributing to one of two available sizes of the buckeye leaf symbol. Leaves can be used to share encouraging or motivational messages with readers and to recognize important mentors and pharmacists in the donor's lives.

Gifts of any amount are welcome in support of this new student learning center, while the recognitions and naming opportunities noted above range from \$8,000 to \$400,000. All commitments can be completed over 1-5 years.



For more information, please contact John Swartz.  
[swartz.9@osu.edu](mailto:swartz.9@osu.edu); 614-688-1834.



THE OHIO STATE  
UNIVERSITY  
COLLEGE OF PHARMACY